

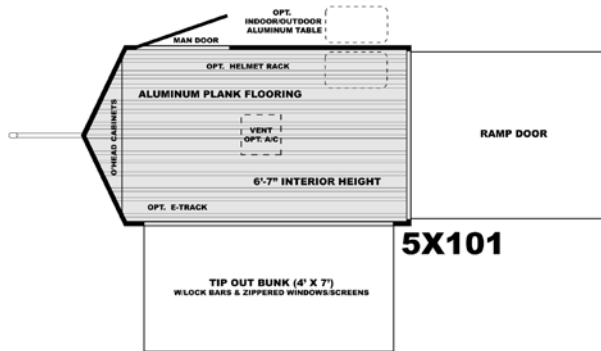

UNIQUE PATENT-PENDING DESIGN



**ULTRA
LIGHT
WEIGHT
CAMPING
CARGO
TRAILERS
MADE
OF ALL
ALUMINUM**



Overall Length: 13'-6" Overall Width: 7'-0"
Overall Height: 101" (113" with A/C)
GVWR: 3,500 lbs. Dry Weight: 1,180 lbs.

**Go Camping with Your
Motorcycles or ATVs!**

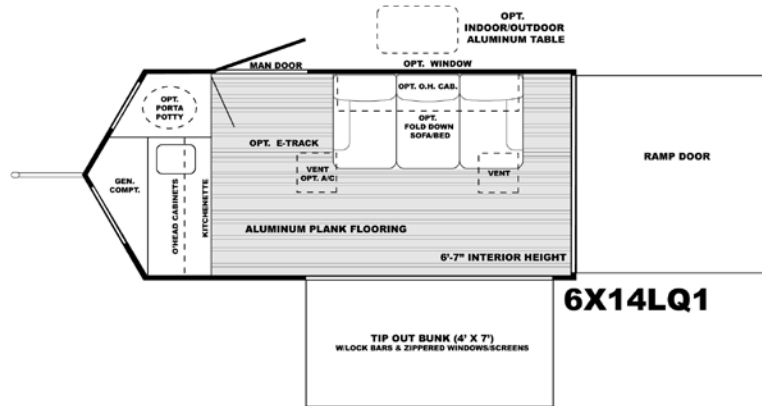
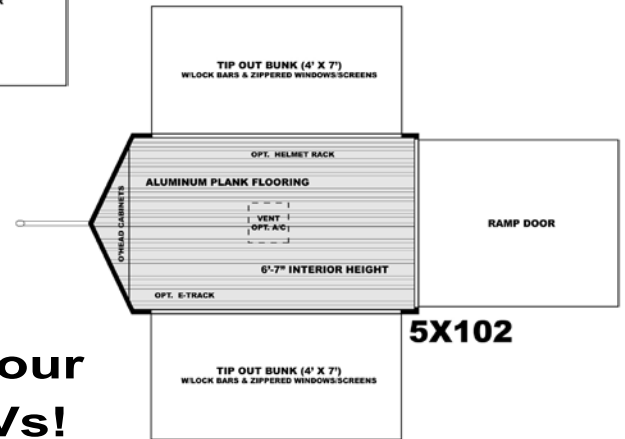

Overall Length: 17'-6" Overall Width: 7'-6"
Overall Height: 101" (113" with A/C)
GVWR: 4,500 lbs. Dry Weight: 1,700 lbs.



**BUILT TO
STAND
THE TEST
OF TIME!**

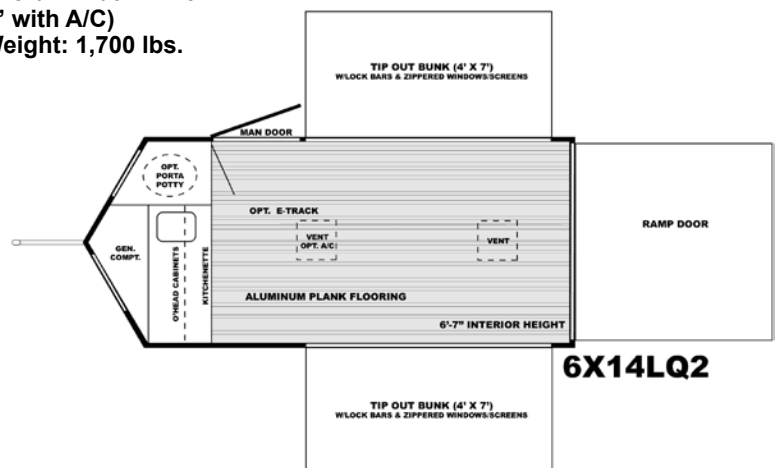

WWW.LIVINLITE.COM

UNIQUE PATENT-PENDING DESIGN

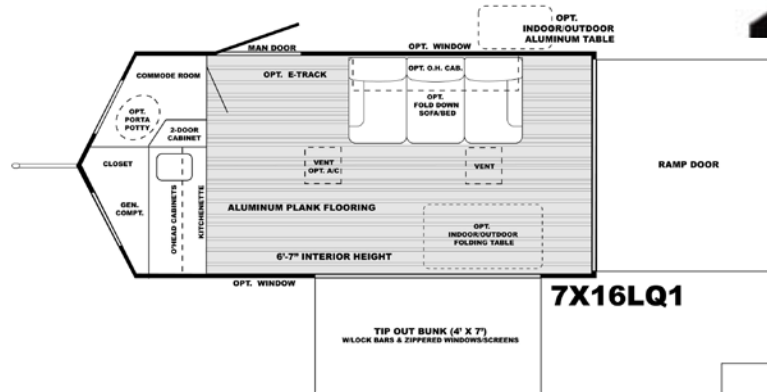

Overall Length: 19'-6"
 Overall Width: 8'-6"
 Overall Height: 101" (113" with A/C)
 GVWR: 6,000 lbs. Dry Weight: 2,195 lbs.

ALL-ALUMINUM CONSTRUCTION

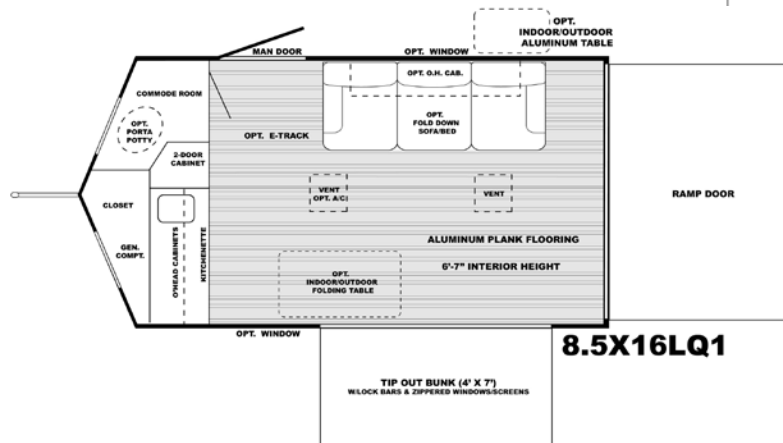
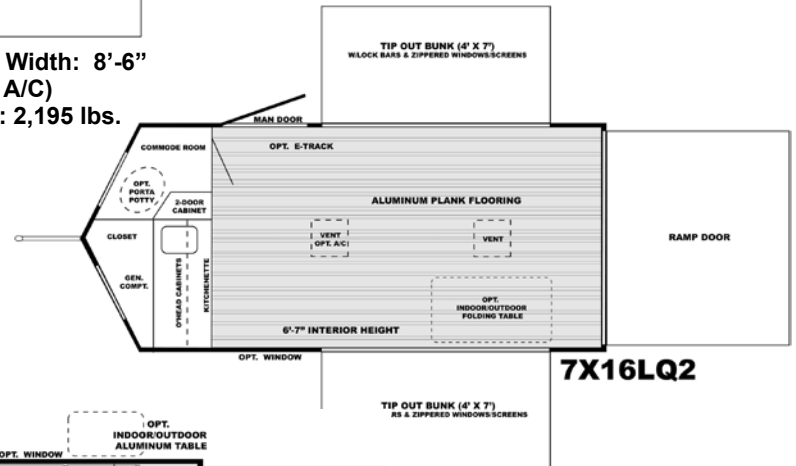

Overall Length: 19'-6"
 Overall Width: 8'-6"
 Overall Height: 101" (113" with A/C)
 GVWR: 6,000 lbs. Dry Weight: 2,595 lbs.

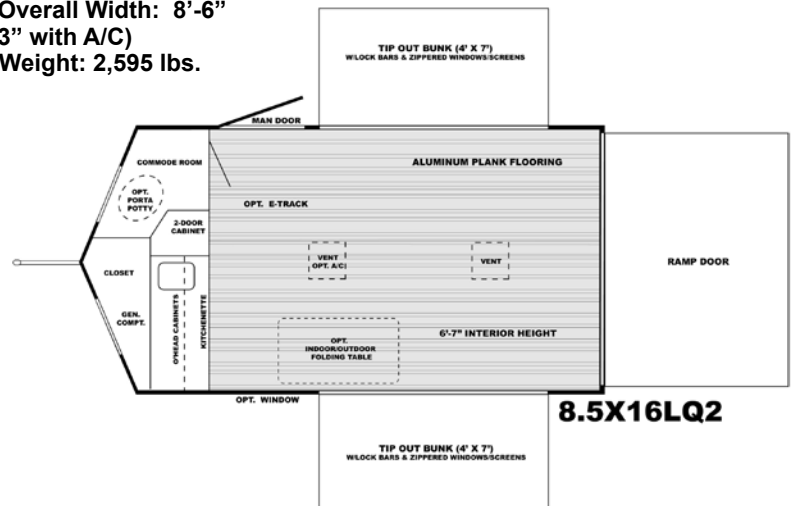

Sleep Comfortably with Your Bikes!

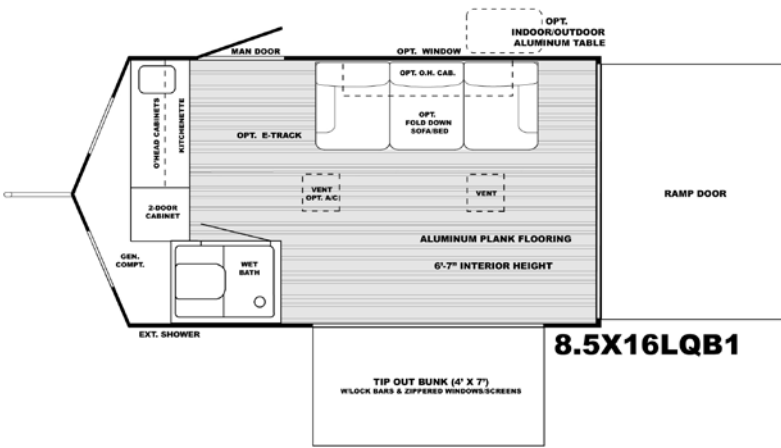

8.5X16LQB1

Overall Length: 19'-6" Overall Width: 8'-6"
Overall Height: 101" (113" with A/C)
GVWR: 6,000 lbs. Dry Weight: 2,795 lbs.

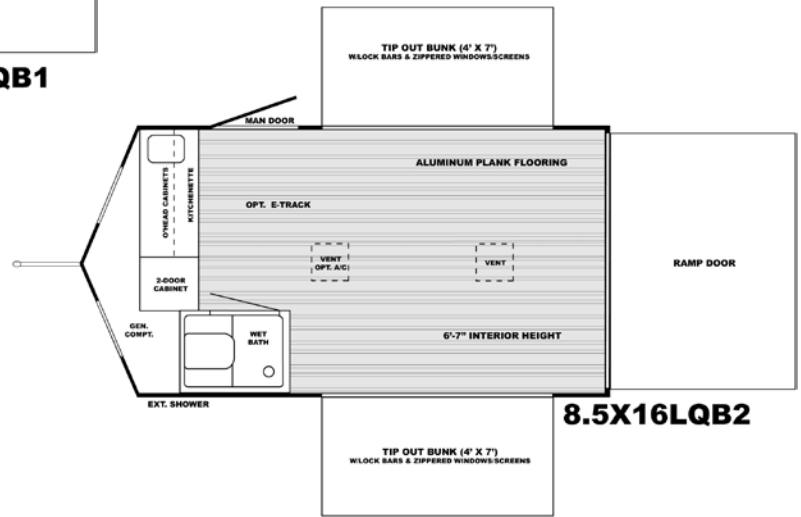

8.5X16LQB2



Pull Down Rear Screen

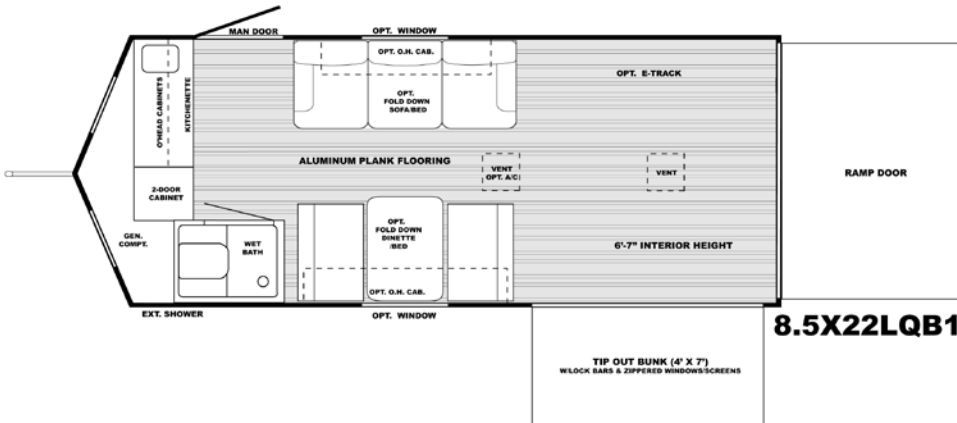

8.5X22LQB1

Overall Length: 25'-6" Overall Width: 8'-6"
Overall Height: 101" (113" with A/C)
GVWR: 10,000 lbs. Dry Weight: 3,595 lbs.

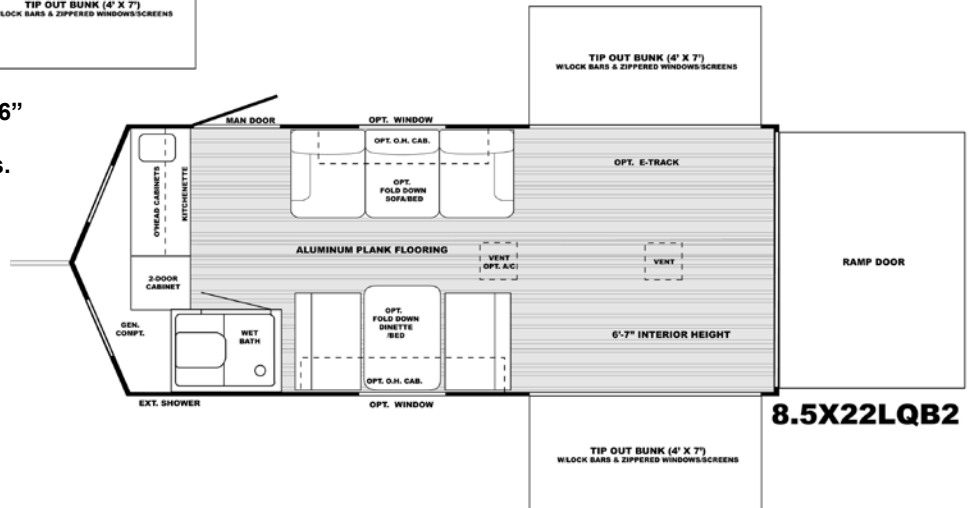

8.5X22LQB2

WET BATH (some models)

- Cassette Commode in Shower Pan
- "Wet Bath" Shower w/Wand
- Electric Water Heater • Water Pump
- City Water Fill • Gravity Fill
- 20 Gal. Fresh Water Capacity



UNIQUE PATENT-PENDING DESIGN

Take Your Family Camping WITH Your Toys!

QUALITY FEATURES

- 1. Tubular Aluminum Frame**
Lightweight; Durable; will not rust away like typical steel frames.
- 2. Dexter™ Independent Torsion Suspension**
Provides the smoothest ride, best tracking and less rebound in all terrains - compared to outdated spring leaf suspensions.
- 3. Inter-Locking Aluma-Plank® Floor Deck**
Lightweight; Durable; will not rot away, sag or have soft spots like typical plywood floor decking. Frankly, there's just no comparison to conventional trailers here.
- 4. Tubular Aluminum Sidewall Framing**
Lightweight; Durable; will not rot away like wood. 1.5" x 3" Tubular Framing at Bunks.
- 5. Aluminum Sidewall Exterior Skin**
Lightweight; Strong; Durable; offers the option of colors vs. competition's white.
- 6. Diamond Plate Aluminum Rockguard and Trim Package (automotive styling)**
Protective; Durable and Adds a Great Look to the Exterior of the Camper.
- 7. Diamond Vinyl Interior Wall Board**
Durable; Cut off 6" from Floor so You Can Spray Out Your Trailer with a Hose.
- 8. Tubular Aluminum Bed Bunk Framing**
Lightweight; Durable; will not rot away, vs. plywood bases of typical bunks.
- 9. Tubular Aluminum Cabinet Framing**
Lightweight; Durable; will not rot away like typical wood studs.
- 10. Aluminum Skinned Cabinetry**
Lightweight; Durable; Clean Look; Designed to stand the test of time - compared with the typical wood paneling.
- 11. Finished Aluminum Cabinet Doors**
Lightweight; Durable; Clean Look; Designed to stand the test of time - compared to typical "presswood" doors.

- 12. Custom Molded Composite Countertops**
Lightweight; Durable; Sink Molded into Counter; Designed to stand the test of time - compared with the laminated "presswood" tops (most models).
- 13. Fully Insulated Construction**
Lightweight Block Foam Insulation is Packed into the 1-1/2" Thick Sidewalls and 4" Thick Roof of each Trailer.
- 14. Strong Aluminum Roof Rafter System**
Lightweight, yet Very Strong Rafters.
- 15. Heavy-Duty, Durable Tent Bunks Sets Up Easily in just minutes**
Offering zippered windows with screens; and upgraded bar locks when closed.
- 17. 6'-7" Interior Headroom**
No more bending over in your bike trailer! Enjoy the ability to walk around with plenty of clearance!
- 18. "Living Quarters" Available (most models)**
Features a full array of aluminum cabinetry including kitchenette with base and overhead storage; a pantry; a closet inside the commode room!
- 19. 12V Power Vent in Ceiling**
This powered air vent moves the air inside the VRV for more pleasant living conditions!
- 20. Upgraded Side Vents**
These stainless steel vents (not plastic) provide necessary air flow while in transit and can be closed or opened by hand!

- **Protective Bag Covers at Bunks**
These durable protective covers allow you to protect the bunks and mattresses from the vehicles or other items you store inside the VRV during travel.

- **Available Porta-Potty Room/Closet**
Convenient privacy with exterior door access. Can be used for storage or for a porta potty (porta potty is optional).

OTHER STD. EXTERIOR FEATURES:

- **77" Ramp Door Opening**
Designed to accommodate even the largest ATV or Utility Vehicles
- **Spring Balanced Ramp Door**
No Cables, No Head Spring; Easy Lift
- **Aluminum Mag Wheels**
- **Four Stabilizer Jacks**
- **Safety Chains**
- **Lighted, Molded License Plate Cover**
- **Exterior Entrance Step**
- **Man Door on Side**

POPULAR OPTIONS

- **13,500 BTU A/C Unit (with Heat)**
- **Awning (size varies per unit)**
- **Interior Cabinetry Packages**
- **Tip-Out Bunk Beds**
- **Porta Potty**
- **Wet Bath Design**
- **E-Track Floor Tie Down System**
- **Lightweight Indoor/Outdoor Table**
- **Windows (where applicable)**
- **Overhead Cabinets**
- **Exterior Graphics Packages**
- **Exterior Roof Rack**
- **Custom Designed Trailers -**
LIVIN LITE is known for working with our customer to make their dream trailer a reality. As such, we are willing to work with you to take your concepts and incorporate them into a unique, all-aluminum trailer that will not only meet your unique needs, but provide you with years of care-free, lightweight towing use. Talk to your dealer about having LIVIN LITE build a custom trailer for you.

OTHER INTERIOR FEATURES:

- **Comfortable Mattresses on the Bed Bases**
Lightweight; Durable; Mattresses are designed to be easily removable for washing.
- **12V&110V Electrical Outlets**
Providing Convenient access to electric for fans, heaters, coolers, lights, etc.
- **Hand-Pump Sink Faucet (where applicable)**
For fast and convenient access to fresh water. Comes with a 8-gallon water tank.



1025 E. WATERFORD • WAKARUSA, IN 46573 • PH. 574.862.2228

WWW.LIVINLITE.COM

All illustrations and specifications contained in this literature are based on the latest product information at time of publication. Livin' Lite Recreational Vehicles, Inc., reserves the right to make changes in prices, colors, materials, equipment and specifications at anytime without notice or obligation. All units are shipped F.O.B. Wakarusa, Indiana.
CONSULT YOUR LOCAL DEALER FOR WARRANTY INFORMATION. 10M 10/09

Your Dealer